

Congratulations on purchasing your new Engineered Wood Flooring!

Engineered wood floors offer a value-for-money, good quality, timber flooring option. Made from pre-finished, multi-layered engineered boards, with a “wear layer” of top quality hardwood, they are easy to lay, simple to maintain and are particularly suited to under floor heating.

This step-by-step guide will take you through preparation, installation and maintenance.

PREPARATION FOR INSTALLATION

Storing Engineered Wood Flooring

Please store Engineered Wood Flooring cartons flat on the ground. Keep the cartons sealed. The storage room should be about 18 degrees Celsius and have a relative humidity of 45-60%.

Conditioning the room before installing your Engineered Wood Flooring

Before moving the Engineered Wood Flooring into the room where it will be installed, please ensure that:

- Painting and wallpapering are complete.
- Plaster is dry.
- Floor and wall tiles have been installed for at least 3 weeks.
- Windows are in place.
- Radiators have been bled.
- No re-humidification takes place in the room where the floor will be installed.

Acclimatising your Engineered Wood Flooring

Place the Engineered Wood Flooring cartons in the room at least 72 hours before installation.

Ensure a room temperature of about 18 degrees Celsius and relative humidity of 45-60% before, during and after installation.

In winter, particularly with low temperatures and dry air, you may wish to use a humidifier.

Planning

In square rooms, lay the floor in the direction of the incoming light, in rectangular rooms, lay it length-wise.

Installation Tools

Hammer, saw, measuring tape, square, pencil, fitting bar, tapping block, wedges and glue.

THE SUB-FLOOR

The sub-floor should be dry, clean, firm and level (maximum unevenness of 2mm per linear meter).

The sub-floor's residual moisture should not exceed 3%.

A NOTE OF CAUTION

Wood is a natural product and subject to variations in colour, grain structure and geometry. For this reason, up to 5% of your Engineered Wood Flooring may not be useable for its intended purpose.



UNDER-FLOOR HEATING

It is imperative that you use the services of a professional wood flooring fitter and that they follow the under-floor heating instructions carefully.

Among other things, you should make sure that:

- The moisture content of the sub-floor does not exceed 1.5% (cement) or 0.3% (anhydrites).
- The heating has been on for at least 3 weeks before laying the floor.
- The sub-floor surface temperature does not exceed 27 degrees Celsius.
- The heating has been switched off for at least 24 hours before laying the floor.
- Eight days after laying the floor, the heating is switched on and temperature gradually increased (increasing 2-3 degrees every 24 hours).
- The planks are glued down directly onto the sub-floor or use secret nails into the joist/battens.

INSTALLATION

We recommend that you “float” your Engineered Wood Flooring:

1. Use PE sheets (2mm thick) as a vapour barrier under the floor.

PE sheets should overlap (about 20 cm) or be tightly joined to avoid vapour leakages. PE sheets should be laid upward on the walls so that any rising residual moisture from the sub-floor can escape along the sides.

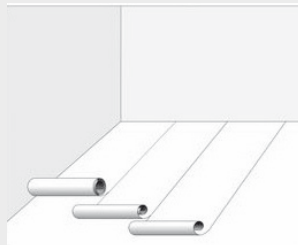

2. Open the Engineered Wood Flooring cartons right before installation starts.
3. Work out of 4-5 cartons at any given time and select the most appropriate plank for every space.
4. As this is a natural product it is possible that up to 5% of the boards may be unusable.
5. Use a guide running along the wall to ensure that the first row of planks are laid straight.
6. Use wedges to create 12-15mm expansion gaps at walls, door thresholds, pipes, stairs, etc. Large spaces require larger expansion gaps (2mm increments for every 1 metre of flooring width). When installing through several adjoining rooms, provide expansion joints at every door's threshold.

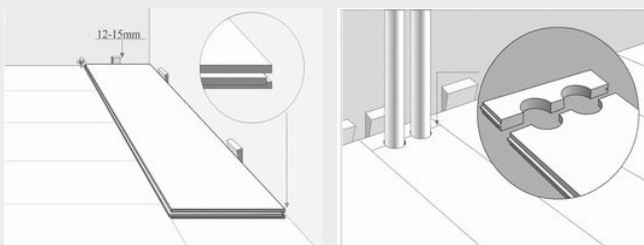

7. Lay the first plank with its grooves towards the walls (corner) and work towards your right. Apply a continuous layer of glue on the groove tops, also on the grooves at the head joints.

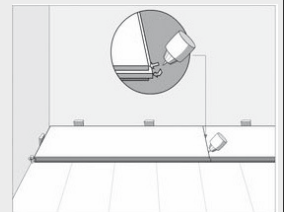

8. Gently hammer onto the tapping block so that it pushes the planks into the adjacent ones.

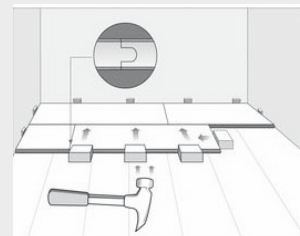

9. Remove any excess glue with a damp cloth.
10. When installing the last plank in a row, turn the plank 180° and place it over the next-to-last plank (tongue facing tongue); mark the last plank with a square and saw it; install the last piece with the help of a fitting bar; adjust a wedge between the plank and the adjacent wall.

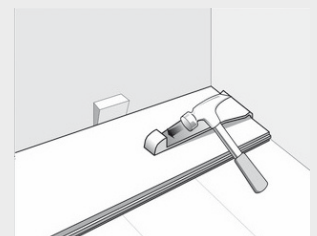

11. Start the next row with the piece of plank remaining from the previous row, as long as it is long enough.

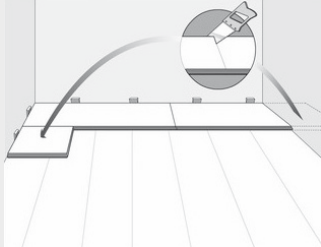

12. Stagger the heads of the adjacent planks in order to produce a pleasant visual effect.
13. You may need to cut the last row of planks lengthwise as it may not fit exactly against the wall.
14. Make sure that there is enough space above the installed Engineered Wood Flooring for the door to swing.

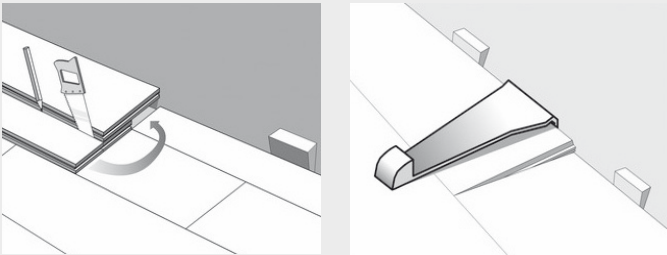

15. Leave the wedges in place overnight and then take them out and cover spaces as appropriate.

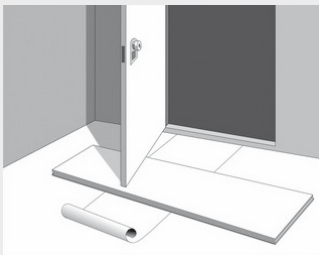

16. Screw the skirting onto the adjacent wall.

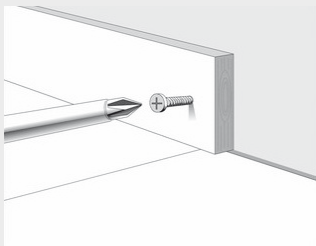

17. Make sure the room is well ventilated and free from any excess building moisture.

If you decide to glue your Engineered Wood Flooring, please use the services of a professional parquet layer.

MAINTENANCE INSTRUCTIONS

Lacquered Engineered Wood Flooring

- You may wish to use a protective treatment just before starting using your Engineered Wood Flooring
- Make sure your room temperature is about 18 degrees Celsius and relative humidity between 45-60%.
- Place felt or alike under furniture legs.
- Place a floor mat at every entrance.
- Use dry cleaning methods such as wiping, dry mopping or vacuuming. Avoid water.
- Remove sand or dirt immediately as it may scratch your Engineered Wood Flooring.
- Remove dirt and stains with a gentle detergent and a damp (NOT wet) sponge, mop or cloth.
- Never use aggressive detergents or products containing ammonia or silicones. Consult your local flooring shop for specialized maintenance products.

Oiled Engineered Wood Flooring

Please purchase specialized quality soap and quality maintenance oil at your local flooring shop.

Please follow the manufacturer's advice. Among others:

- The floor should be free from dirt or residue before cleaning.
- Dissolve soap into a warm (not hot) water solution 1/40 or as recommended by the soap manufacturer.
- Always work with 2 buckets. One with soap water and the other with clean water to rinse the mop.
- Wash the floor lengthways, using a damp (not wet) floor mop.

Your Online Timber Supplier

TimberCut4U
Parker Kislingbury Ltd
Wotton Road
Brill
Buckinghamshire
HP18 9UB

Email: contact@timbercut4u.co.uk

Telephone: 01844 239900

Fax: 01844 238016